

## PEM 2.5" GN Hub Parts Schematic

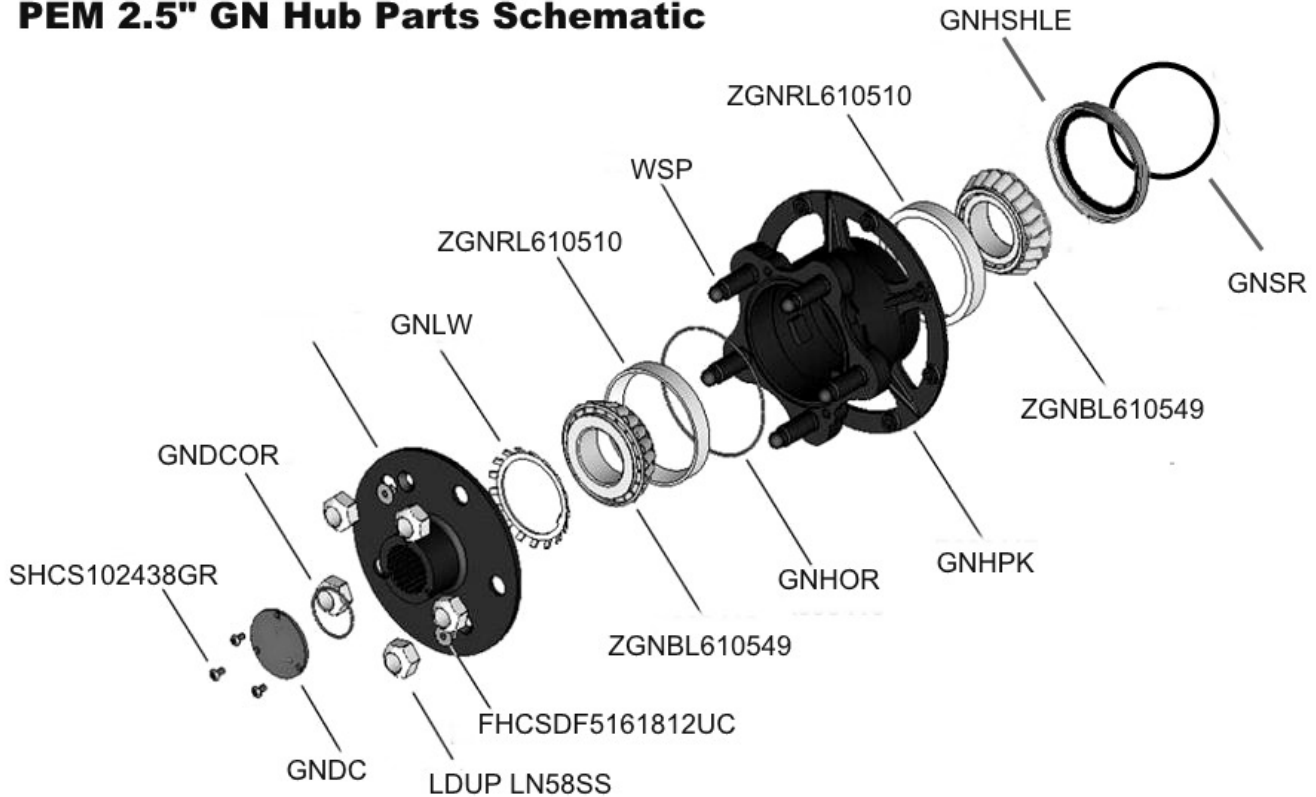

### Parts

**GNHP** - partial kit with studs and races installed ( 4.75 or 5x5" bolt pattern)

**GNDF** - drive flange , bare ( 4.75 or 5 x 5" bolt pattern)

### Torque Specifications

**Rotor Bolt Torque Settings** 5/16" coarse socket screw, 180 inch pounds

**Socket Head Screws for Dust Cap** apply anti seize compound and hand tighten with allen wrench

**Tapered Drive Flange Screws** apply anti seize compound and hand tighten with allen wrench

**GN Hub Nut** Grease wheel bearings with hi-speed wheel bearing grease. Insert back side wheel bearing and install hub seal and retaining snap ring. Slide hub on GN snout and inset front wheel bearing, lock washer and install GN Snout nut. Snug up nut with a socket till it gets harder to turn hub. Then back off 1/8 turn and flip the locking tabs on lock washer in the recess on the snout nut. Wheel bearings are usually set by feel so there are many ways of installing. Also there are now low drag spacers made that go between the two hub bearings and you have to go by the spacer manufacturer instructions.

After nut is tightened you can install the axle. Please use high pressure grease on the axle splines before you install the drive flange. Slide drive flange over the axle and onto the wheel studs. Make sure the two screw holes line up with the hub screw holes. Usually you can install the drive flange with the axle in the rear end. Make sure and put anti-seize on the flat head tapered screws because with use they will get really tight and will be almost impossible to remove if assembled dry.